

I. Summary

Strip cutter is the special equipment for leather, synthetic leather, cloth, rubber sheets, plastic sheets, etc. The stripping width can be adjusted at your disposal. The operating handle can control the stripping length and position at random. Its structure is advanced, and the operating and maintenance are very convenient. It is the ideal equipment for tanning industry, leathergoods, rubber goods, paper products, etc.

II. Main technical parameter

	<i>XJ₃B₂</i> 型	<i>XJ40</i> 型
Knife rotating speed	40 rpm	Same
Velocity of feeding	10 m/min	Same
Stripping width	adjusted at a random range	Same
Stripping length	no limited	Same
The max. thickness of skiving	8 mm	Same
Working width of knife roller	320 mm	400 mm
Knife specification (mm)	φ80×φ40×1	Same
Electronic motor	0.55 KW 1400 rpm	0.55 KW 1400 rpm
Voltage	380 V or 220 V	Same
Net weight	64 kg	78 kg
Measurements (L×W×H) (mm)	700×345×340	770×345×350

III. Usage and adjustment

1. Lubricating: (No start before adding oil)

(1). User should turn-on the oil entrance cap 81 before new machine is operated, adding mechanical oil and observing the oil meter 37. It's ok to notice that oil level rises up to a settled position. (generally mechanical oil has been added enough before new machine leaves from plant)

(2). Each oil entrance spot (oil cup and red oil hole) should be added by mechanical oil. (generally mechanical oil has been added enough before new machine leaves from plant)

2. Startup

Start the power motor, control the foot panel, observing whether the rotating direction of the knife is right or not. If its direction is reverse, turn off the power and change the phase of the power.

3. Adjustment

(1). Choose the appropriate gasket 20 according to the width of the stripping.

(2). Turn over the guardboard 79 of the organic glass, loose the round nut 22 by the special spanner (see the picture 3) and the brace handle 31, put down the bracket 24 and exiting the knife 21 and the special gasket 20.

(3). Install the special gasket and knife, screw on the round screw cap 22, set up the bracket 24, screw tight the round nut 22 by the special spanner.

(4). Uninstall the bracket 67 of the feeding panel (see the picture 5), re-install the exiting panel 65, impact the feeding panel into the knife axis and adjust the right pressure by adjusting the bolt 71.

(5). Put down the guardboard of the organic glass for safety before starting to work.

(6). Adjust the localizer bar 76 on the working station.

(7). Operate the handle 63 and make the nylon gasket 44 on the nether roller to stick firmly the knife for making strips.

(8). The machine adopts the mechanical clutch motor. Operator controls the pedal by foot and controls the incision speed and shut down freely.

IV. Maintenance

1. Often observe the oil meter 37, and add oil in time when out of oil.
2. Each oil entrance spot should be added oil two times every shift.
3. Once finding the made-to-order nylon gasket on the nether roller damaged seriously after a long time use, the incisory work pieces probably become burr. Thus uninstall the fore/back cover board 73/75 on the working table. Loose the nut 16 by the special spanner and the bolt 50 (3 pieces), and uninstall the pole 46. Extracting the nylon gasket, and re-installing it by changing its position.
4. **If user wants to cut the work pieces with a peculiar width, more knives and special gasket should be needed, please mail or call us.**

V. Samples of parts

(Type XJ40 and XJ₃B₂ have the same shape, so most of their parts are the same except some ones concerned with length.)

1. Machine-head
2. Mechanical clutch motor
3. Strap wheel ϕ 65
4. Strap V model Z (model O) 900
5. Strap wheel ϕ 115
6. Worm $m=2.5$ right rotation
7. Fore-axletree cover
8. Axletree <<30204>> (old model 7204)
9. Inner hexagon column-head bolt $M6 \times 16$
10. Axletree <<6204>>
11. Framework-type rubber oil seal $20 \times 40 \times 10$
12. Back-axletree cover
13. Worm wheel
14. Round nut $M24 \times 1.5$
15. Main (knife) axis
16. Insulating oil loop
17. Insulating sheath
18. Gear $m=3$ $Z=20$
19. Bush $\phi 30 \times \phi 38$
20. Special gasket $\delta=1.5, 2.0, 5.0$
21. Knife
22. Round bolt $M40 \times 1.5$
23. Bush $\phi 24 \times \phi 32$
24. Bracket
25. Base cover
26. Top spring M10
27. Nut M10
28. Inner hexagon plane fixed bolt $M10 \times 50$
29. Gasket
30. Conical pin ϕ 5
31. Adjustable fixed handle M10
32. Right base cover
33. Bush $\phi 20 \times \phi 28$
34. O-type loop 22.4×1.8
35. Press cover
36. Cross-head bolt
37. Round oil meter $\phi 16 \times \phi 25$
38. Oil exit screw cap M10
39. Inner hexagon column-head bolt $M6 \times 14$
40. Gear $m=3$ $Z=20$
41. Gasket
42. Inner hexagon column-head bolt $M6 \times 10$
43. Nether roller
44. Nylon gasket
45. Round nut $M22 \times 1.5$
46. Left swing pole
47. Right swing pole
48. Bush $\phi 18 \times \phi 24$
49. Bush $\phi 18 \times \phi 24$
50. Inner hexagon column-head bolt $M8 \times 25$
51. Support axis
52. Back support seat
53. Hexagon-head bolt $M8 \times 30$
54. Support frame
55. Adjustable bolt M10
56. Gauche wheel
57. Conical pin ϕ 5
58. Support seat (1)
59. Hexagon-head bolt $M6 \times 25$
60. Backstop loop
61. Inner hexagon column-head bolt $M6 \times 10$
62. Support seat (2)
63. Handle seat
64. Ball-head handle
65. Feeding panel
66. Feeding-panel support axis
67. Feeding-panel support seat
68. Inner Hexagon column-head bolt $M6 \times 20$
69. Holding bar
70. Holding bar screw M8
71. Adjustable nut
72. Rubber bar
73. Back cover
74. Cross-head bolt $M5 \times 8$

- 75. Fore cover
- 76. Localizer bar
- 77. Half-head bolt M6
- 78. Adjustable nut M6
- 79. Organic glass guardboard
- 80. Guardboard support seat (one set)
- 81. Oil entrance screw cap M12
- 82. Frame (one set)
- 83. Kick starter (one set)

- 84. Table plate
- 85. Electric switch
- 86. Rubber cushion
- 87. Hexagon head bolt M6×25
- 88. Inner hexagon column-head bolt M8
- 89. bracket
- 90. Adjustable nut

VI. Packing list

1. Main machine packing case : 690 × 380 × 380mm, gross weight : 70kg
 - (1). Main machine: 1pcs
 - (2). Strap cover: 1pcs
 - (3). Oil gun: 1pcs
 - (4). Round nut handle: 2pcs
 - (5). Handle for adjustable bolt 55: 1 pcs
 - (6). Special gasket 20 $\delta=5$: 3pcs
 - (7). Round nut M40×1.5: 1pcs
 - (8). Strap V Z-type (O-type)---900: 1pcs
 - (9). Inner hexagon handle M6 and M8: 1pcs each
 - (10). Bolt M8×70: 4set
2. Table plate packing case: 1120×590×115mm, gross weight: 30kg
 - (1). Table plate: 1pcs
 - (2). Frame: 1 set
 - (3). Kick starter: 1 set
 - (4). Drawer: 1pcs
3. Motor packing case: 420 × 310 × 250mm, gross weight: 22kg
 - (1). Motor: 1pcs
 - (2). Switch: 1pcs



图 4 Fig4

Main Machine

主机

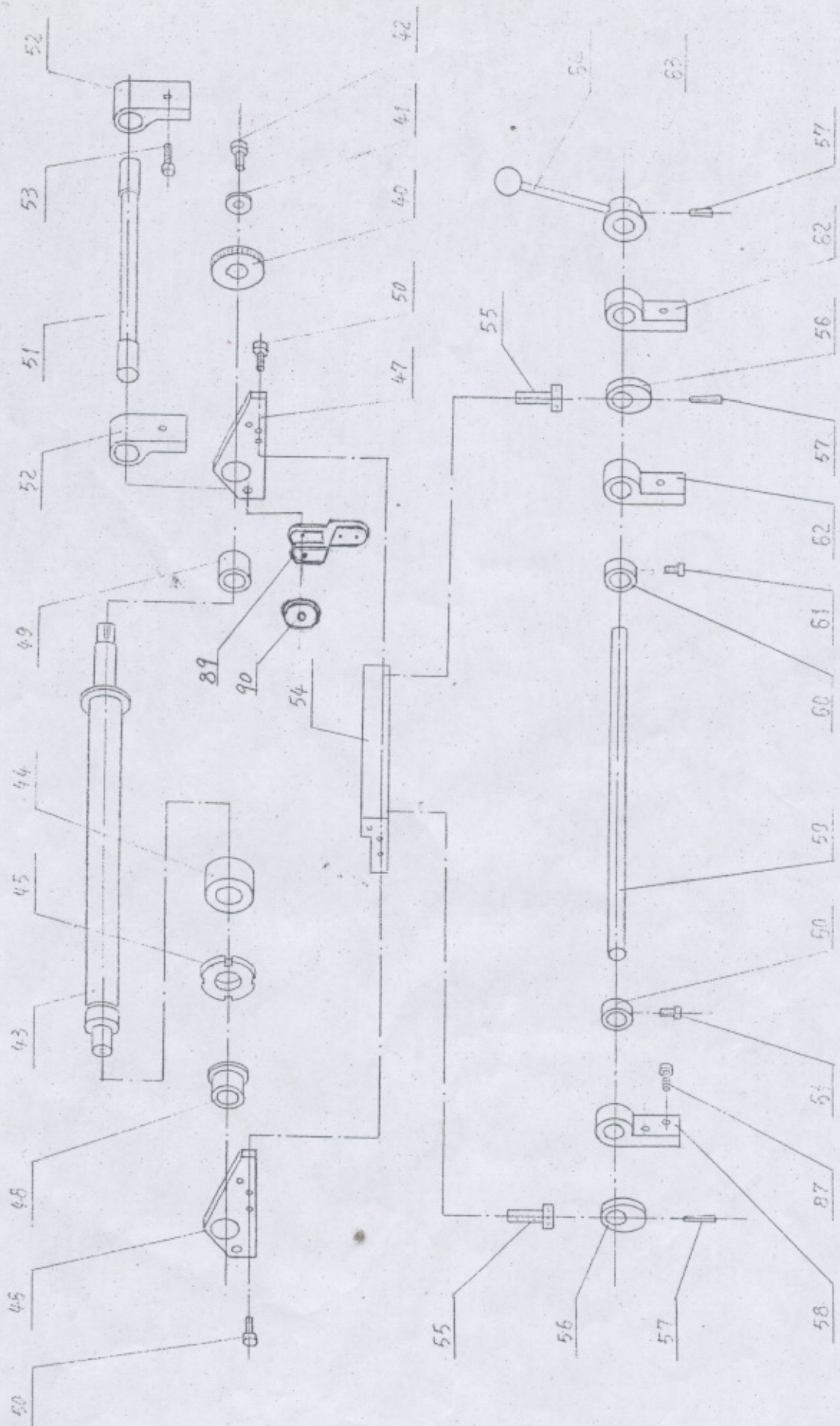

图 1 Fig1



图 2 Fig2

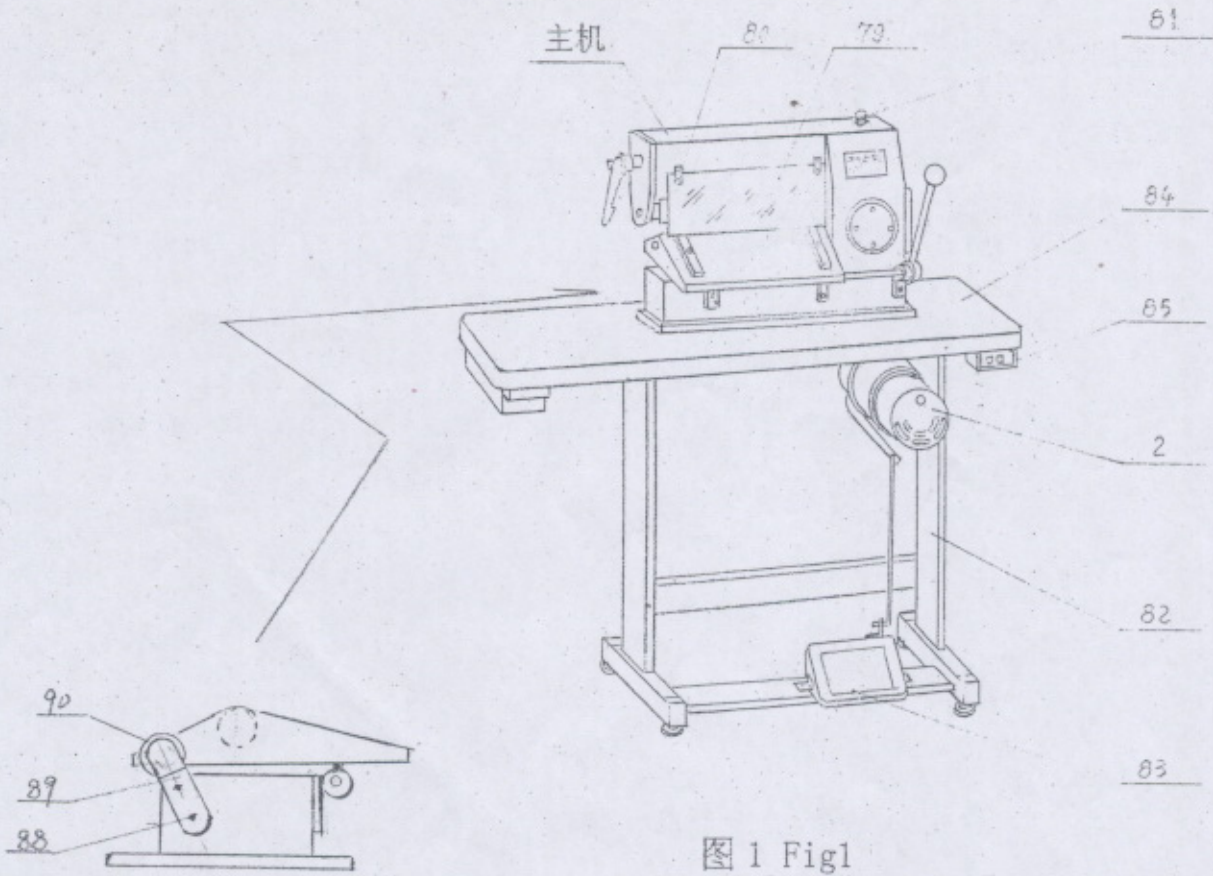

图 5 Fig5

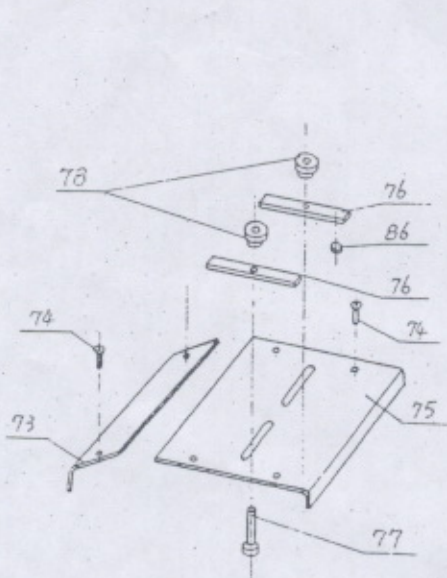
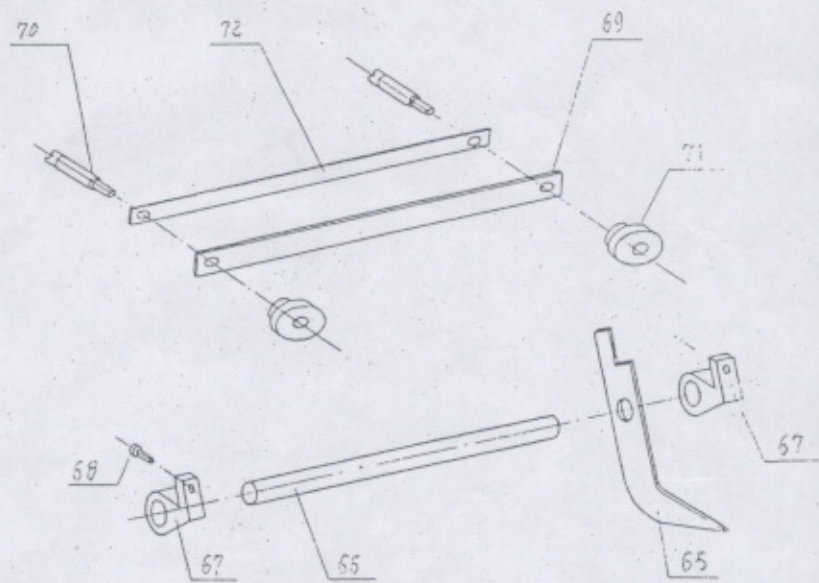
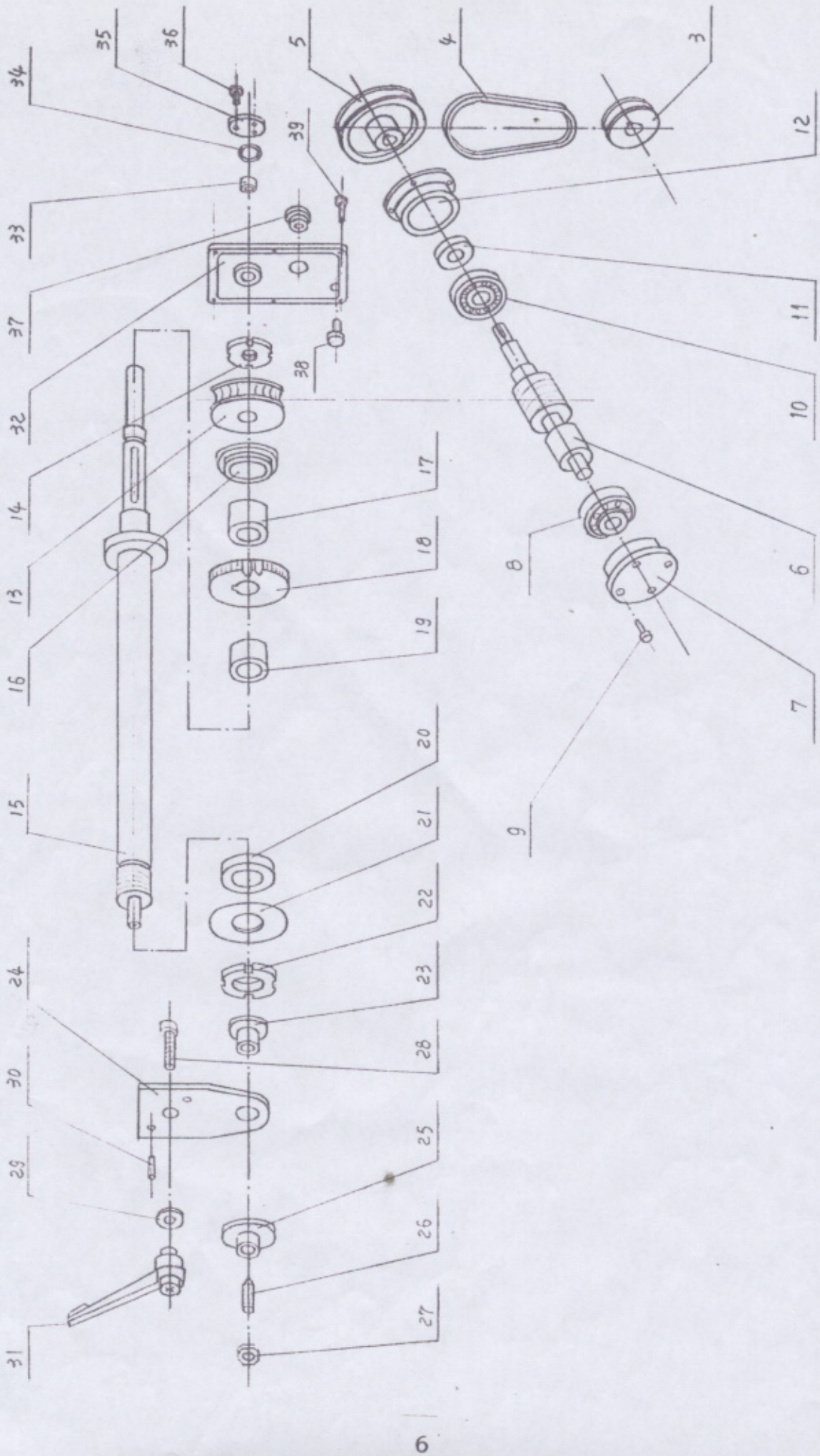

图 3 fig3